

MONARFLOOR® ACOUSTIC BATTEN: INSTALLATION INSTRUCTIONS

Before You Start

These instructions are applicable to the installation of Monarfloor® Acoustic Batten.

Tools & equipment required

- 1 litre of Monarfloor® Acoustics Adhesive for every 21.5m² of deck (approx).
- Note:** Adhesive should be applied in well vented rooms.
- 1 linear metre of Monarfloor® Flanking Band for every 1m² of flooring.
- Utility knife and straight edge.
- Joinery hand/power tools.

Check sub-floor is suitably prepared

- Ensure the surfaces are structurally sound, clean and dry.
- All internal partitions should be installed and built of the sub-floor.
- Kitchens and bathrooms should also be built of the sub-floor (see Monarfloor Generic Kitchen & Bathroom Detail Drawings).

Care of materials

Materials must be kept in a dry storage area at all times.

Working safely

Working on any building site can be a hazardous activity. Only suitable persons having appropriate competence, training and physical fitness should be allowed onsite.

Personal Protective Equipment (PPE) must be worn at all times.

Installing a Monarfloor® Acoustic Batten

Step 1

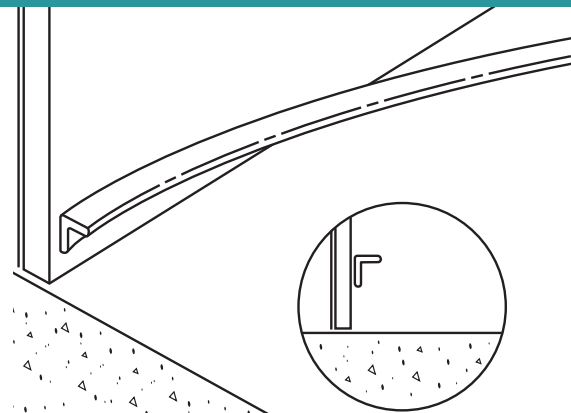

Flank all the perimeter with Monarfloor® Flanking Band.

Note: For every 1m² of flooring you will need 1 linear metre of Monarfloor® Flanking Band.

Step 3

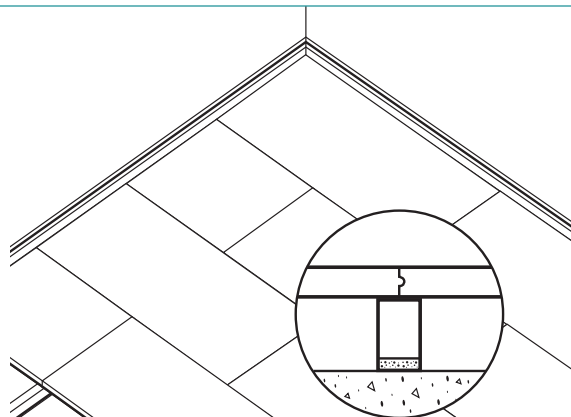

Overlay the Acoustic Battens with an 18mm or 22mm tongue and groove chipboard deck laid in a broken bond pattern perpendicular to the Monarfloor® Battens with all joints supported and glued with Monarfloor® Acoustic Adhesive.

Step 2

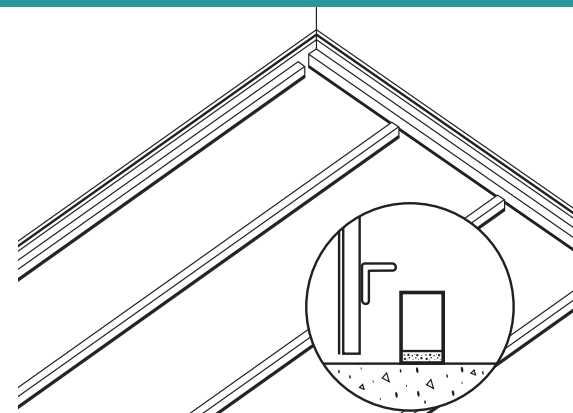

Lay Monarfloor® Acoustic Batten either foam side up or foam side down at 400mm centres (maximum) with a continuous run of batten 50mm in from all perimeter walls.

Step 4

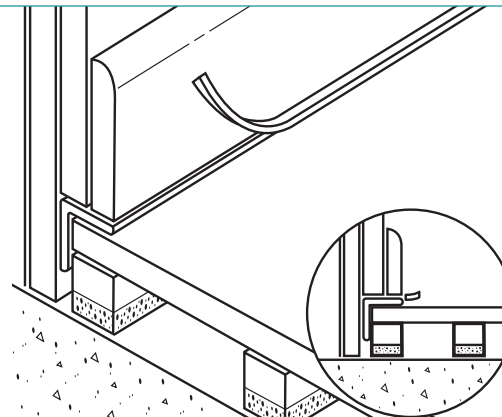

When the deck is fully laid install skirting and trim off excess Monarfloor® Flanking Band.

Where specified install the appropriate acoustic ceiling beneath to complete the installation.