

CI/SfB	July 2017
Uniclass	
Issue 01	

# Monarfloor Tranquility System

## Sound Protection

### Monarfloor Tranquility System

Acoustic isolation membrane system for party floors. Monarfloor Tranquility reduces impact and flanking transmission through separating party floors by isolating wood and laminate floors from the concrete or timber sub floor.

Monarfloor Tranquility is self adhesive and bonds to the sub-floor to reduce the impact noise whilst ensuring its robustness.

Monarfloor Tranquility also improves the thermal comfort of the floor and can be laid in both new-build and renovation projects

### Features and Benefits

- Isolates wood and laminate floors from the sub floor reducing impact noise transmission.
- Has superior dynamic stiffness, acoustic isolation and damping performance.
- One part self-adhesive system.
- Improves thermal comfort of the floor
- Is suitable for hard or soft surface coverings and concrete or timber sub-floors in new build and refurb projects
- Surpasses performance requirement of Approved Document E of the Building Regulations
- Complies with Robust Details bonded resilient floor cover (E-FC-8)
- For sites that are to be pre-completion sound tested, Monarfloor Tranquility can provide a quick and easy route to up to 4 cost-neutral Sustainable Homes Credits (when used as part of a system).

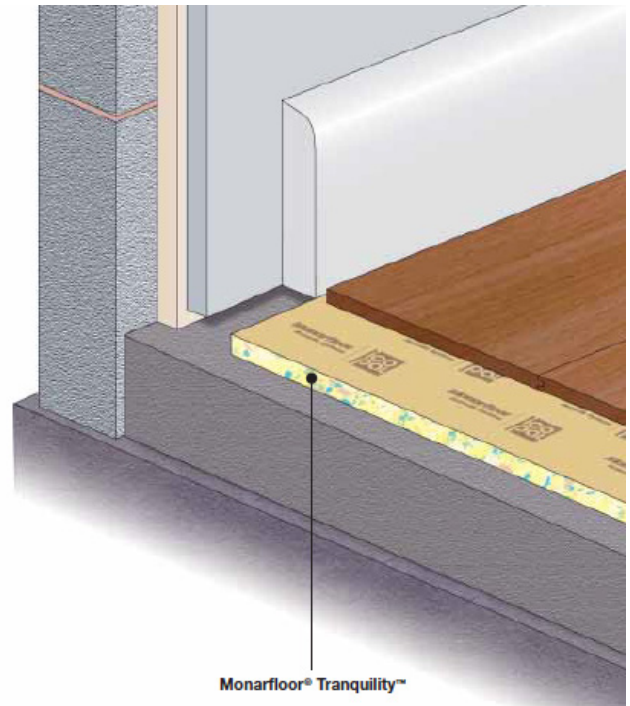

### Construction

Monarfloor Tranquility is a self adhesive composite system comprising a layer of LRAC foam sealed both sides with a polyethylene membrane.

*For full details refer to our Product Information and Safety Data Sheet.*

### Product Data

<b>Roll size</b>	10m long x 1,5m wide
<b>Thickness</b>	8mm
<b>Roll weight</b>	20kg (max)
<b>ΔLw (Part E)</b>	37dB direct onto membrane 22dB with 6mm MDF overlay.



EN 13707 15 0086-CPD-505779

Ref: ICO1905

CI/SFB	July 2017
Uniclass	
Issue 01	

# Monarfloor Tranquility System

## Sound Protection

### Installation at a glance

- Ensure sub floor is structurally sound, clean and dry.
- Roll out Monarfloor Tranquility over the surface area. Butt tight to all perimeters.
- After setting out the Tranquility, it should be bonded to the sub-floor by peeling back the backing paper and adhering with the self-adhesive backing.
- Butt tight the second layer of Tranquility to the first and, if required, tape the joints.
- The wood or laminate floor can then be laid as a floating layer over Monarfloor Tranquility.
- For carpet, soft coverings or files refer to Monarfloor Technical Department.

For full details including carpets and soft covering, refer to our Monarfloor Tranquility Installation Sheet, contact our Technical Services or visit our website: [www.monarfloor.co.uk](http://www.monarfloor.co.uk)

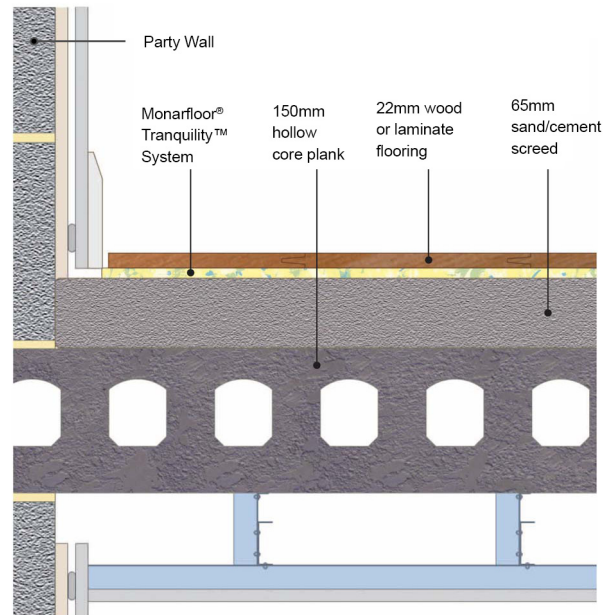

**Monarfloor® Tranquility® over 65mm sand/cement screed and 150mm precast concrete plank (other applications are acceptable, please contact Monarfloor® Technical Services).**

### Technical Support

Monarfloor Acoustic Systems offers FREE technical advice and assistance on all aspects of acoustic systems.

We can also undertake site visits to provide contractors with advice and assistance at every stage of a project from concept to completion.



EN 13707 15 0086-CPD-505779

Ref: ICO1905