

Construction Notes:

Staifix HRT4 wall ties, or equivalent (TYPE A) should be used in conjunction with the Bridgestop System, and punctured through at 900mm centers

(A) Power floated R.C slab on 50 - 75 mm max oversite concrete binding - mix GEN1, laid on a smooth level finish on Dot Type 1 well compacted fill down to strip level to Engineers approved raft foundation. (Other continual slab details are acceptable with this system).

(B) 30mm EPS70 expanded polystyrene perimeter insulation ('k' value 0.037 W/mK)

(C) 85mm EPS70 expanded polystyrene perimeter insulation ('k' value 0.037 W/mK)

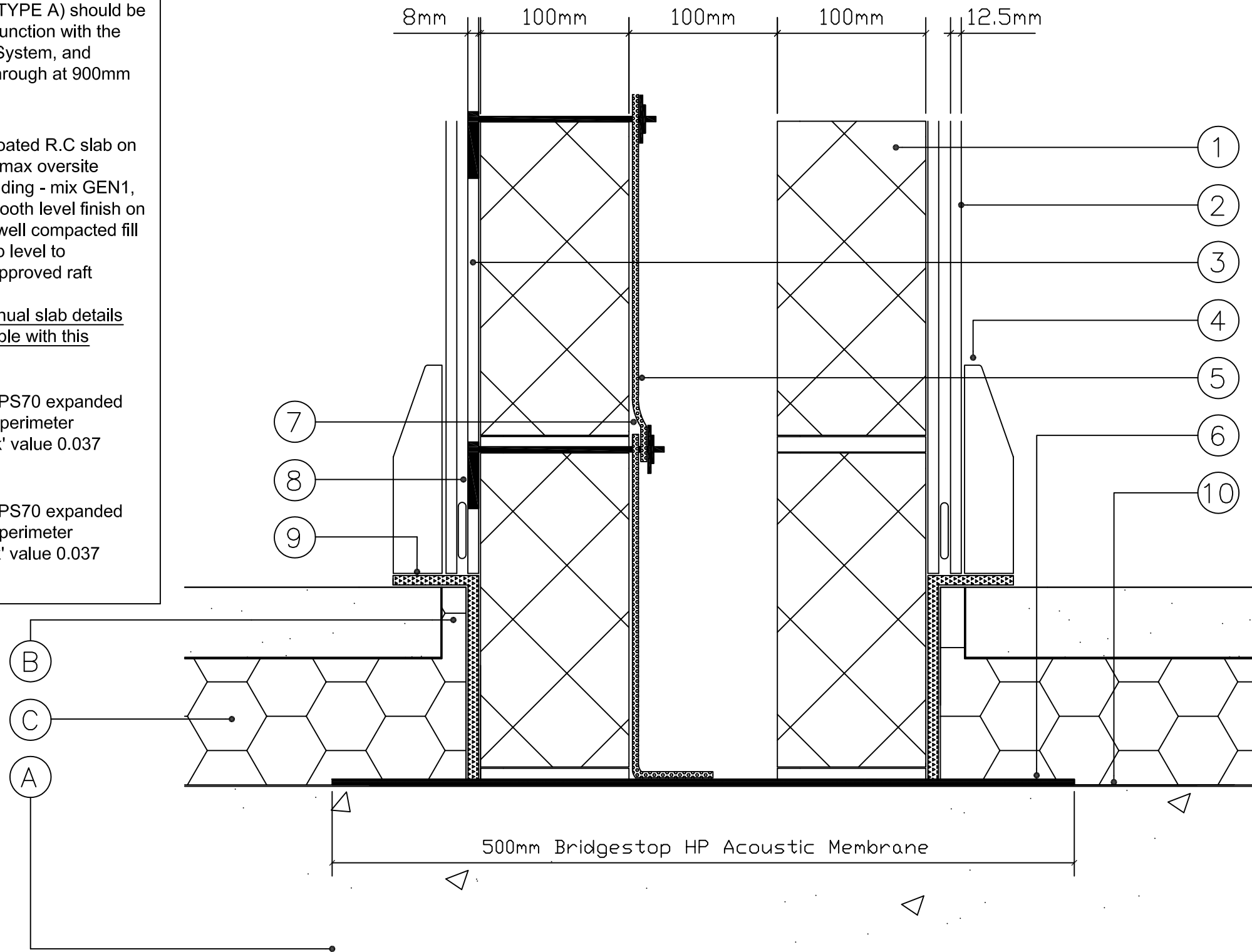

Bridgestop® System within a typical party-wall detail, allowing continued raft foundation between dwellings and 4 credits within Code for Sustainable Homes (based on PCT (mean) field test evidence)

This detailed drawing is to recommend the correct procedures for installing MONARFLOOR products. All other building details are shown indicatively and are not to be used for building construction

Key Notes:

- ① **AGGREGATE BLOCKS**
(Acceptable for use within the system)
Dense Aggregate 1850 - 2300 kg/m³
Lightweight Aggregate 1350 - 1600 kg/m³
Besblock "Star Performer"
- ② Gypsum - based board (nominal 8kg/m²) on dabs (or 13mm plaster)
- ③ Nominal 8mm render coat with gypsum - based board (nominal 8 kg/m²) mounted on dabs.
- ④ Skirting board isolated from finish screed with Monarfloor® Acoustic Angled Flanking Band
- ⑤ Monarfloor® Bridgestop System within the party cavity-wall
- ⑥ Monarfloor® Bridgestop HP Acoustic Membrane laid under the party wall, Icopal 400 RMB lapped at party wall, this is an integral part of the system.
- ⑦ Monarfloor® Bridgestop Quilt in two lifts to prevent mortar droppings touching both masonry skins.
- ⑧ Monarfloor® Bridgestop Tie with render depth marker, to penetrate at 450mm centers (max). Ties are reversible.
- ⑨ Monarfloor® 6mm Acoustic Angled Flanking Strip (not included within Bridgestop System)
- ⑩ Icopal Ultra 400 RMB, 150mm laps and sealed to bridgestop membrane with 100mm laps at party wall (where required dependant on LABC)

Project: **Icopal / Napier Joint Development**

Title: **Bridgestop System with Typical Insulated Screed over Continual Raft**

Building Performance Center



Monarfloor® Acoustic Systems



Drawn: **LN** Scale: **NTS**

Date: **July 2009**

ICO1378 - issue 8

© THIS DRAWING AND DESIGN THEREIN IS THE EXCLUSIVE PROPERTY OF ICOPAL – MONARFLOOR ACOUSTIC SYSTEM. IT SHOULD NOT BE COPIED OR REPRODUCED WITHOUT CONSENT AND SHALL BE USED ONLY IN REFERENCE TO MATERIALS OR GOODS SUPPLIED BY THEM.

This drawing has been prepared for general information purposes only. (Do not scale)