

Monarfloor® Tranquilt® System

Lightweight acoustic isolation system for floating screeds.

Monarfloor® Tranquilt® reduces impact and flanking transmission within pre-cast and in-situ concrete floors in new-build and refurbishment projects by forming an isolation layer between the sub floor and the finished screed.

When installed as part of a complete sound reduction system it enables a concrete floor surpass to the sound insulation performance requirements for separating party floors in Approved Document E of the Building Regulations.

Construction

Monarfloor® Tranquilt® is a composite system comprising a layer of LRAC™ foam sealed both sides with a polyethylene membrane.

For full details refer to our Product Information and Safety Data Sheet.

Product Data

Roll Size	20m long x 1.5m wide
Thickness	10mm
Roll Weight	17.5kg
DnT,w + Ctr	50dB
LnT,w	≤50dB
Typical mean values based on 150mm precast planks.	

Installation

See over for details.

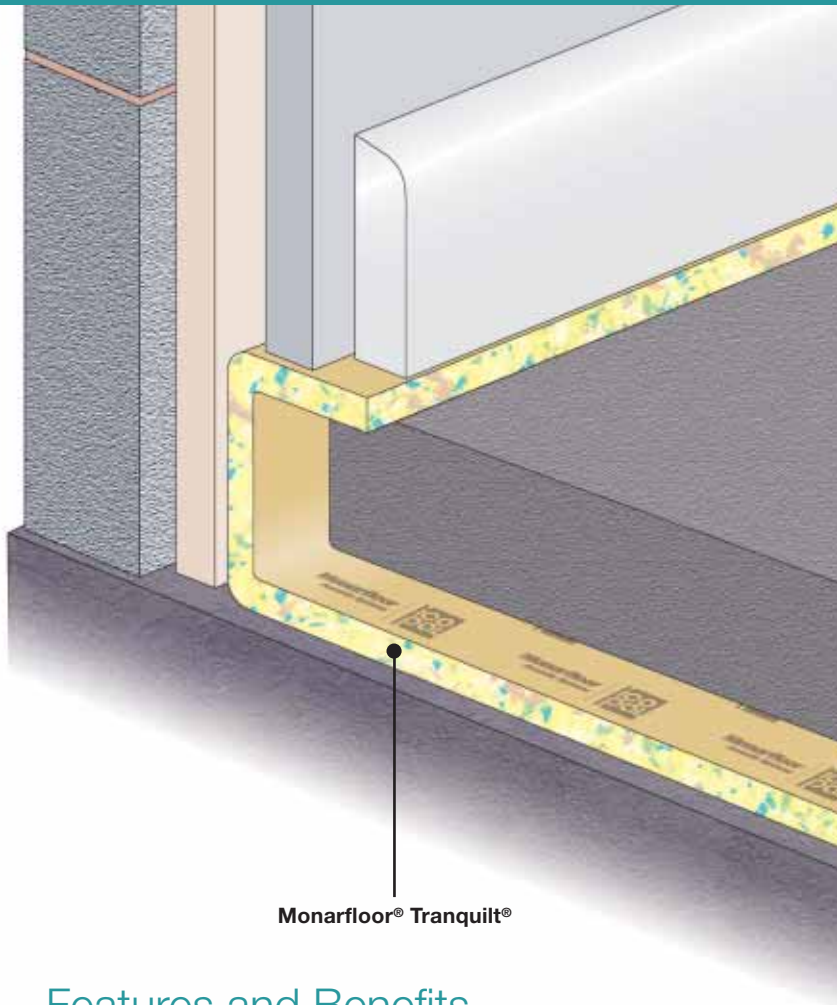

Monarfloor® Tranquilt®

Features and Benefits

- Isolates finished screed from the sub floor reducing sound transmission.
- Has superior dynamic stiffness and acoustic isolation performance.
- Superior acoustic damping properties.
- One part system with integral flanking, jointing and corners that are formed in-situ.
- Can be used with sand/cement and proprietary screeds without the need for additional polythene or waterproofing membrane.
- Lightweight and easy to handle and install.
- Surpasses performance requirements of Approved Document E of the Building Regulations.
- For sites that are to be pre-completion sound tested, Tranquilt® provides a quick and easy route to up to 4 cost-neutral Sustainable Homes Credits (when used as part of a system).
- Specified within Robust Details E-FC-11 (as of April 2009 – refer to Robust Details Handbook for fully compliant specification).



robustdetails



High Performance Acoustic Systems for
New Build, Conversion and Refurbishment.



Monarfloor® Tranquilt® System

Installation at a glance

- Ensure concrete sub floor is structurally sound, clean and dry.
- Roll out Monarfloor® Tranquilt® over the concrete sub floor with the jointing strip to the upper surface face. It is advised that all the Tranquilt® be loose laid out over whole floor area to ensure that it's positioned correctly before joining.
- Turn the perimeter edges up to all perimeters, 150mm minimum.
- Butt edges tightly together, with the overlapping polyethylene uppermost and glue to adjoining Tranquilt® using Monarfloor® Acoustic Adhesive.
- Form the corners to the contour of the up-stands and adhere with Monarfloor® Acoustic Adhesive. Ensure sufficient upstand to fold over to flank any skirting or architrave.
- Lay a minimum of 65mm sand and cement or minimum 40mm proprietary screed over the Tranquilt®
- Complete construction and install skirting using the protruding Tranquilt® to form an isolation between skirting and screed, trimming off any excess flush with the skirting.

For full details including advice on services and penetrations refer to our Monarfloor® Tranquilt® Installation Sheet or visit our website animation: www.monarfloor.co.uk/tranquiltinstallation

Technical Support

Monarfloor® Acoustic Systems offers FREE technical advice and assistance on all aspects of acoustic systems.

We can also undertake site visits to provide contractors with advice and assistance at every stage of a project from concept to completion.

Icopal Limited

Barton Dock Road, Stretford, Manchester M32 0YL
Telephone: 0161 866 6540
Fax: 0161 866 6527
Email: acoustics.uk@icopal.com

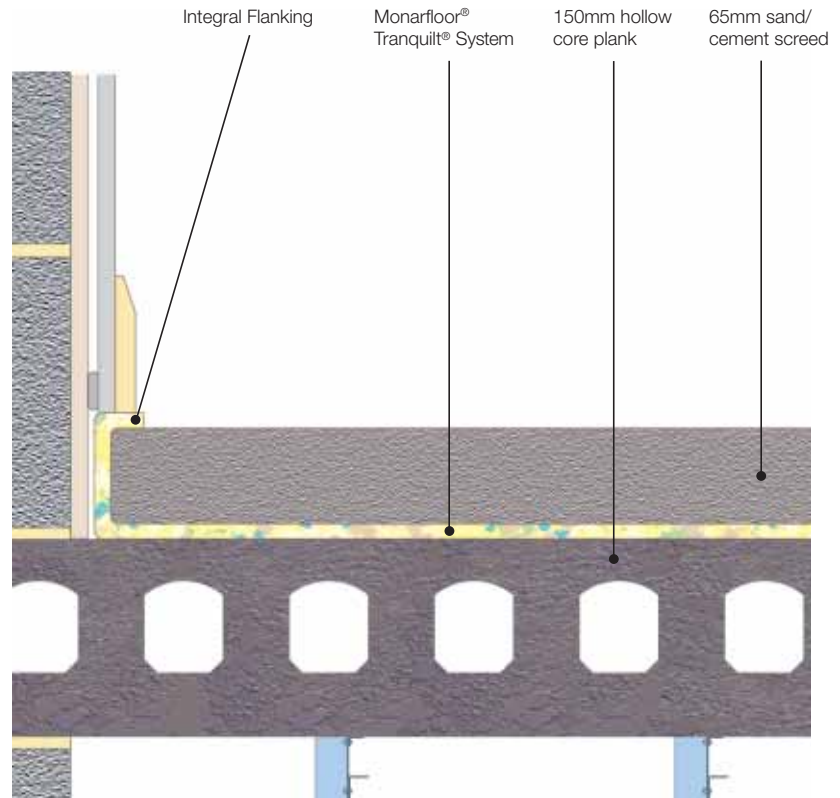

Monarfloor® Tranquilt® over 65mm sand/cement screed and 150mm precast concrete plank.

Related Products

- **Monarfloor® Wall Cap 400 System** – acoustic isolation system for separating party cavity walls within multi-rise developments.
- **Monarfloor® Wall Cap 200 System** – acoustic isolation system for separating flanking walls within multi-rise developments
- **Monarfloor® Bridgestop® System** – acoustic isolation system for party walls on raft foundations or continual slab.
- **Monarfloor® Acoustic Adhesive**

For full details refer to individual Monarfloor® Product Data Sheets.

NOTE: This information is given in good faith being based on the latest knowledge known to Monarfloor® Acoustic Systems. Whilst every effort has been made to ensure the contents of the publication are current while going to press, customers are advised that products, techniques and Codes of Practice are under constant review and liable to change without notice. Up to date information is available from our Technical Services Department on request.

Responsibility cannot be accepted for the application of products, and no claims can be considered, where the manufacturer's instructions have not been followed. The user should not assume; based on information provided in this sheet, that the product is suitable for any abnormal use.

All products are sold subject to our standard terms and conditions of sale, a copy of which is available on request.