

MONARFLOOR® WALL CAP: INSTALLATION INSTRUCTIONS



Before You Start

Monarfloor® Wall Cap 400 must be used for party cavity walls and Wall Cap 200 for flanking walls.

Check contents of packs

- **Wall Cap 400**
1 x roll Wall Cap 400 membrane, 30 x Wall Cap Clips
- **Wall Cap 200**
1 x roll Wall Cap 200 membrane, 15 x Wall Cap Clips

Other Materials Required

- **Monarfloor® Bridgestop® System** – acoustic isolation system for party walls on raft foundations or continual slab.
- **Monarfloor® Isolation Strip** – acoustic strip designed to reduce sound transmission.
- **Monarfloor® Wall Cap Lamatherm** – acoustic isolation strip for vertical use.

Tools & Equipment Required

Sharp knife and straight edge.

Check walls are suitably prepared

Ensure walls are structurally sound, clean and dry.

Working Safely

Working on any building site can be a hazardous activity. Only suitable persons having appropriate competence, training and physical fitness should be allowed onsite.

Personal Protective Equipment (PPE) must be worn at all times. Good and safe working practices should be followed at all times, details of which can be obtained from the Health & Safety Executive.

Care of Materials

Materials must be kept in a dry storage area at all times.



Installing Monarfloor® Wall Cap Systems

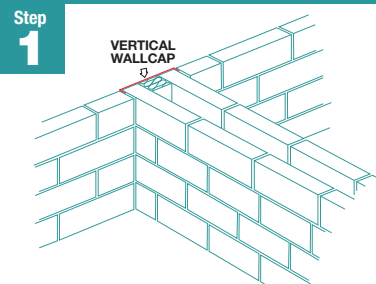

Build both load-bearing party walls and flanking walls to the desired height.

Note: Monarfloor® Wall Cap Lamatherm membrane should have been installed vertically on flanking walls.

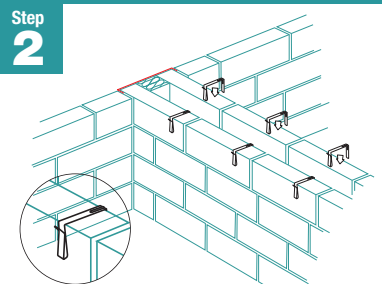

Installing Monarfloor Wall Cap 400 onto party walls. Locate Wall Cap clips equally at approximately 600mm centres on both masonry leaves along the length of the party cavity wall. Fix clips into place by pushing over the masonry blocks.

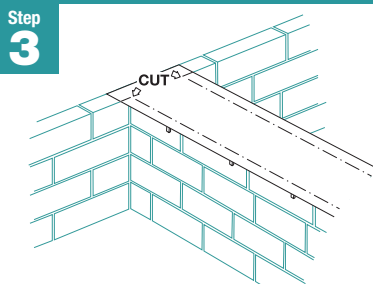

Roll Wall Cap 400 membrane over the full length of the prepared cavity wall. Cut as necessary to fit any joint/shapes.

Note: The membrane should be centred on the cavity wall with approximately 50mm overhanging at each edge.

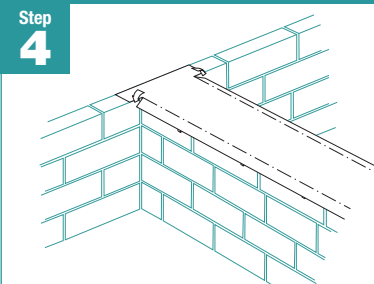

Turn the membrane overhangs down the face of the masonry blocks.

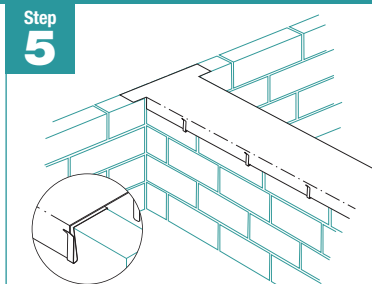

Hold the membrane into place by clipping it into the Wall Cap Clips.

Note: For jointing and detailing, butt the Wall Cap membrane tight and locate further Wall Cap Clips at these junctions.

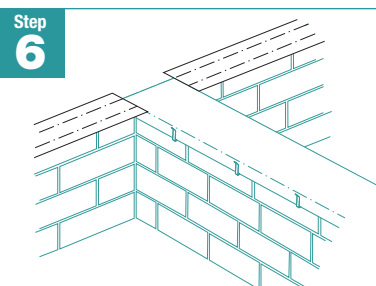

Installing Monarfloor Wall Cap 200 onto flanking walls.

Roll the Wall Cap 200 membrane over the full length of the suitably prepared inner load bearing flanking wall.

Note: The membrane should be centred on the flanking wall with approximately 50mm overhanging at each edge.

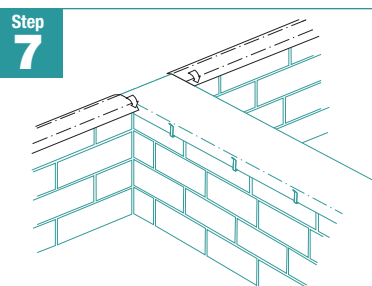

Turn the membrane overhangs down the face of the masonry blocks.

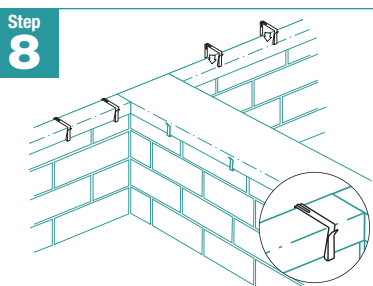

Hold the membrane into place by pushing the Wall Cap Clips over the membrane and the masonry blocks, locating the clips at approximately 600mm centres.

Note: For jointing and detailing, butt the Wall Cap membrane tight and locate further Wall Cap clips at these junctions.

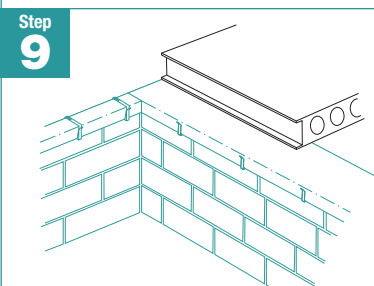

Once all the floors have been isolated install the precast floor planks in the usual manner. Once the floor planks are fully installed, proceed to build the party and flanking walls.

Note: All wall/floor junctions must be isolated in the same manner as the build continues upwards.

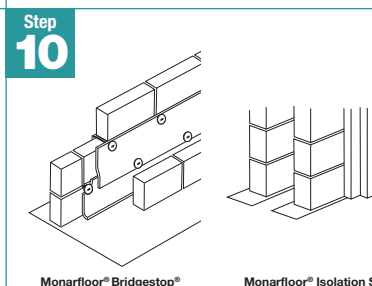

For optimum acoustic isolation, the party cavity wall should have Monarfloor® Bridgestop® built in at every storey and flanking walls isolated from the precast floor slab with Monarfloor® Isolation Strip.